

TRU ACOUSTICS SOUNDPROOF WINDOW INSTALL GUIDE



TABLE OF CONTENTS

- 1** Tools & Materials
- 2-3** Unpacking Instructions
- 4-5** Installing the Window Frame
- 6-7** Glass Installation

DELIVERY INSTRUCTIONS

Upon delivery and before signing, make sure that the crate and packaging shows no sign of damage. If there is damage, take pictures and have the driver sign for the damage. Contact us immediately at **1-800-679-8511**.

TRU ACOUSTICS SOUNDPROOF WINDOW INSTALL GUIDE

MATERIALS INCLUDED

- Window frame
- Snap-fit glass retainers
- Glass unit
- Rubber setting blocks for glass
- Small block of wood for installing glass retainers

TRU ACOUSTICS WINDOW INSTALL KIT INCLUDES

- Shims
- Screws
- Acoustical Sealant
- Backer Rod

RECOMMENDED TOOLS

- Drill
- Rubber mallet
- Protective gloves with enhanced grip
- Suctions cups for glass handling (may be required for large units)

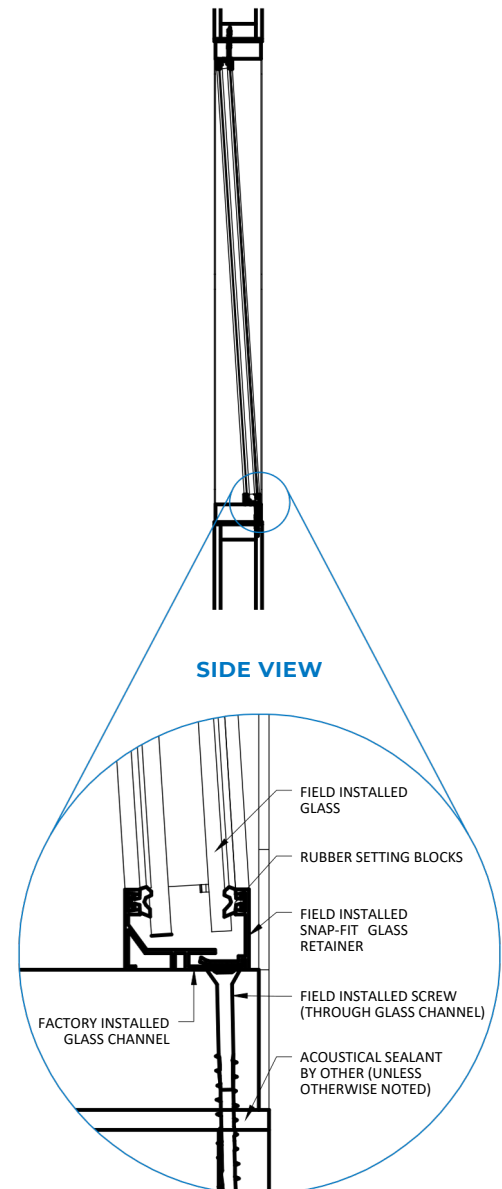
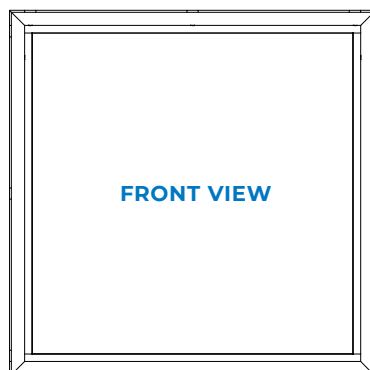

TRU ACOUSTICS SOUNDPROOF WINDOW INSTALL GUIDE

UNPACKING INSTRUCTIONS



Any breakage of glass during shipment must be reported to us upon delivery. Do not sign the BOL without noting damage or the freight will not be covered under freight insurance.

Close crate to protect glass from accidental damage before glass installation.

1

Unscrew board supports from glass crate while another person holds the glass crate upright.



2

With the help of another person, carefully lift glass crate from pallet.



TRU ACOUSTICS SOUNDPROOF WINDOW INSTALL GUIDE

UNPACKING INSTRUCTIONS

- 3 Gently lean up against a flat wall surface.



- 4 Remove the screws from the exposed side of glass crate.



Inspect glass to make sure it is not damaged.



TRU ACOUSTICS SOUNDPROOF WINDOW INSTALL GUIDE

INSTALLING THE WINDOW FRAME

1

The rough opening should be double studded.

Place 1/4" shims in bottom of opening and tack into place. Place frame into opening, center and level with remaining shims.



2

Predrill holes in frame through glass channel as shown at shim locations and install mounting screws.



3

Apply sealant backer material between the outside of frame and wall opening. Recess 1" into gap to allow space for acoustical sealant.

Fill the gap with acoustical sealant between window frame and opening on all four sides completely to eliminate any sound leaks.



TRU ACOUSTICS SOUNDPROOF WINDOW INSTALL GUIDE

INSTALLING THE WINDOW FRAME

4

Apply window trim if required.



TRU ACOUSTICS SOUNDPROOF WINDOW INSTALL GUIDE

GLASS INSTALLATION



GLASS INSTALL: This will be at least a 2 person job and may need to be installed by a professional glazing contractor depending on the scope of the project.

NOTE: If you are installing a Tru Acoustics STC 56 Window; it has an additional piece of glass; make sure you clean the inside surfaces of each completely. After installation the inside surfaces of the glass will be inaccessible.

IMPORTANT GLASS HANDLING: Glass should always be handled wearing gloves and/or using suction cups if needed and placed vertically on, or against a flat cushioned surface (carpet, rubber, foam, etc.); never pickup flat or set directly on or against a hard surface or breakage may occur.

1 Place rubber setting blocks on bottom surface of the glass channel about 4" in from the corners. Some glue or two-sided tape will help hold them in place during glass installation.

For windows with two panes of glass (STC 49, STC 56), check the labeling on the frame to identify which pane of glass goes in which rubber gasket. Do not force the pane of glass into the wrong size gasket!



2 Wearing gloves and/or using suction cups, lift the glass into place and rest the bottom edge on the two setting blocks and up against the rubber seal on the inside of the window jamb. Gently tilt the top of the glass into place making sure it is centered in the opening.



TRU ACOUSTICS SOUNDPROOF WINDOW INSTALL GUIDE

GLASS INSTALLATION

3

While holding glass in place, install aluminum glass retainer by setting it into the glass gutter. Glass retainer should be snapped into place by pressing it in with a piece of blocking or gently tapping it with a rubber mallet.



4

Repeat step 3 for each glass retainer until all are snapped in tight.

Note: For the Tru Acoustics STC 49 and STC 56 Windows, repeat steps 2-4 for the second window pane.



**YOU'RE DONE!
TAKE A SECOND TO ADMIRE
YOUR WORK.**

