

FANTASTIC FRAME WINDOW INSERTS INSTALL GUIDE

RECOMMENDED TOOLS

- Tape measure
- Utility knife
- “Wiss” brand tin snips (yellow handle)
- Caulk gun
- Acoustic caulk sealant
- Electric drill with #2 Phillips bit (or #6 – 3/4” self-tapping pan head screws)
- Rubber mallet and a small 1/2” thick block of wood

ITEMS INCLUDED

- Fantastic Frame window inserts in storage bags
(Note: Do not remove protective film from Fantastic Frame window inserts)
- Metal attachment angles
- Screws
- Foam weather stripping
- Acrylic cleaner and polisher
- Cleaning and polishing cloths

DELIVERY INSTRUCTIONS

Upon delivery and before signing, make sure that the crate and packaging shows no sign of damage. If there is damage, take pictures and have the driver sign for the damage. Contact us immediately at **1-800-679-8511**.

IMPORTANT

Your Fantastic Frame window inserts will install slightly differently depending on your chosen attachment method. Please review the images on page 2 to be sure you are familiar!

FANTASTIC FRAME WINDOW INSERTS INSTALL GUIDE

INSTALLATION METHODS

INVERTED ANGLE MOUNT

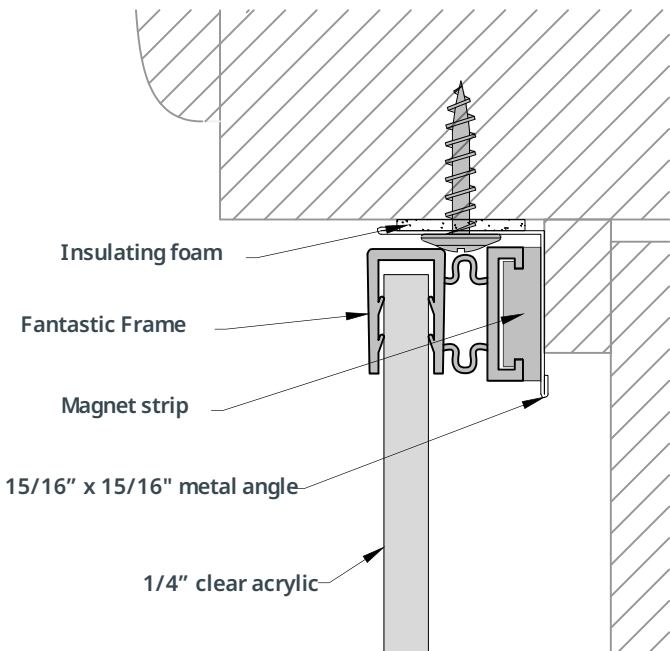

STANDARD ANGLE MOUNT

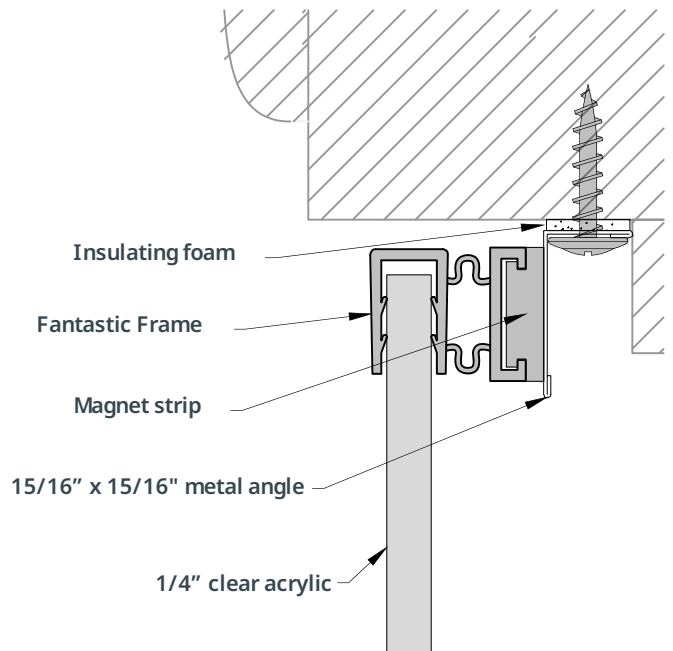

FLUSH MOUNT

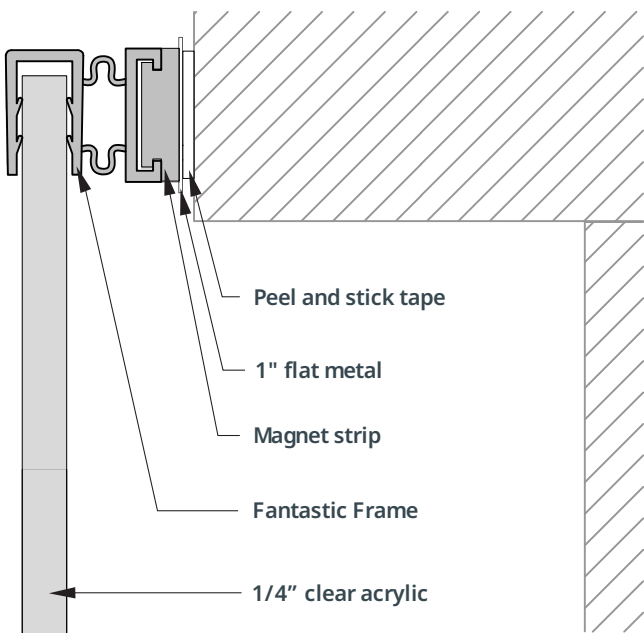

FRAME W/ PAD BOTTOM

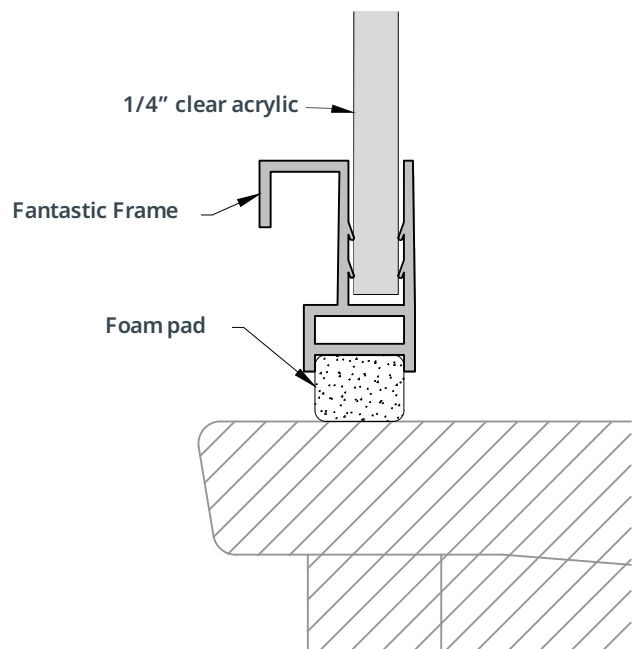

FANTASTIC FRAME WINDOW INSERTS INSTALL GUIDE

INSTALLATION STEPS

1

Note: this first step is only applicable to larger orders. Most orders will have the insulating foam strip pre-installed.

Apply the insulating foam strip along one edge of the attachment angle. The edge to receive the insulating foam strip will depend on the metal trim attachment method. Press down firmly to adhere, eliminating any air pockets from forming. Cut foam at ends with a utility knife. Remove wax paper backing.



2

All attachment angles come several inches longer than needed. Verify measurements of window opening before cutting attachment angle. Start by measuring the top and bottom of your window opening.



3

Measure length on attachment angle and score the angle with a pen, pencil, or utility knife. Use a straight edge to mark lines and then cut off excess metal with yellow-handle "Wiss" tin snips.

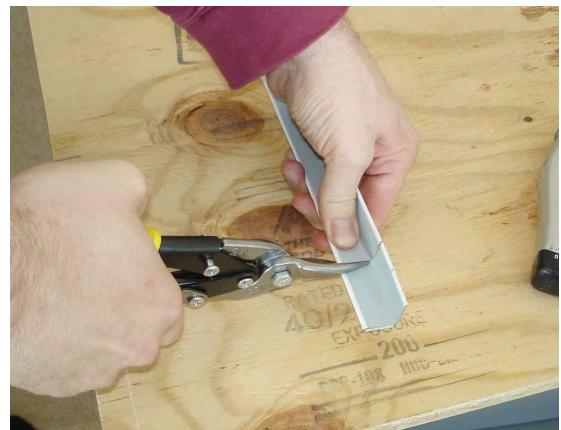

FANTASTIC FRAME WINDOW INSERTS INSTALL GUIDE

INSTALLATION STEPS (CONT.)

4 Once both the top and bottom angles are cut to length, remove the adhesive film from the insulating foam strip. Place angle into window opening such that the insulating foam strip is against the window jamb. Insert screws 2" in from each end and every 12-16 inches.

For deeper window jambs, install the window insert as far away from the window as possible. Every time you 2x the distance to the window, you'll reduce noise by an additional ~3db.



5 Once the top and bottom angles are in, hold vertical angles in place. Score angle and cut with tin snips for exact fit.

Once vertical angles are cut to length, remove the adhesive film from the insulating foam strip, and place angle into window opening such that the insulating foam strip is against the window jamb. Insert screws 2" in from each end and every 12-16 inches.



6 Use acoustical sealant at the corners where metal trim pieces meet and where they intersect with the window jamb or sill. To get behind two metal angles, squeeze out a dab of caulk onto your finger and apply to back side of angle as shown.

The metal pieces should be sealed - no air gaps - and be a flat surface for the window insert to magnetize to.

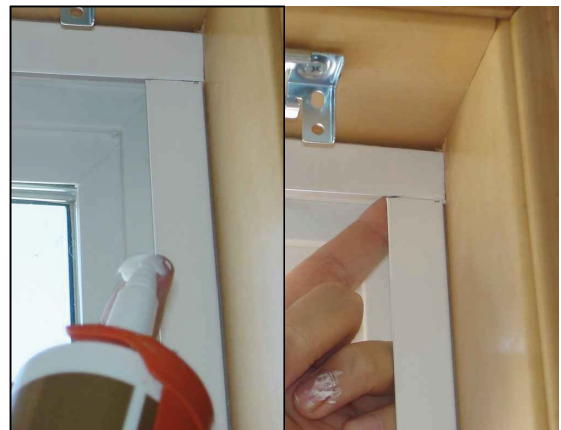

FANTASTIC FRAME WINDOW INSERTS INSTALL GUIDE

INSTALLATION STEPS (CONT.)

7 Do not remove protective film from the acrylic until all steps are complete. Place Fantastic Frame insert into window opening by placing bottom in first. Then tilt the window insert up until magnets have snapped into place.

Once you are sure the window insert fits properly into the window, you may remove it and lay it on a clean floor with the interior face down. If you have multiple similarly sized windows, make sure the right insert is in each window! The window insert should fit "snugly".

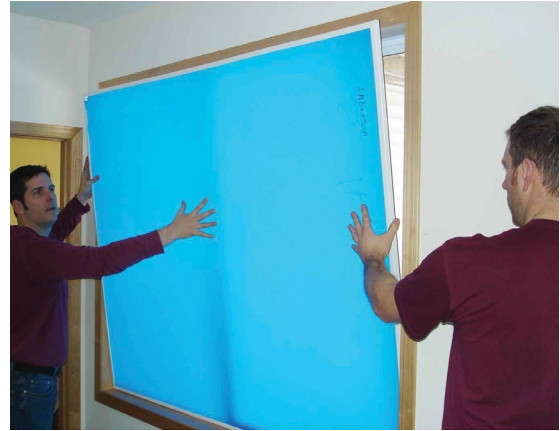

8 Remove exterior facing protective film only and apply Brillianize cleaner liberally across acrylic surface. Then use the WYP-All cloths.

- 1) Wipe in linear motions across the surface area to spread cleaner and pick up any debris that may be on the acrylic.
- 2) Use the next cloth in the same linear motion to bring the remaining cleaner to a fine bead.
- 3) Use another cloth in the same linear motion to dry the surface completely. Do not leave the surface wet and allow to air dry, as this can leave a residue on the acrylic.



9 Do not remove protective film yet! Check your install for gaps. The metal trim and window insert together should be sealed, ideally with as little metal trim showing as possible. Each side of the window insert has about 1/4" wiggle room if we need to increase the size.

For a pad bottom, tap the "handle" of the sill trim with the rubber mallet until the insulating foam on the bottom has a good seal with the window sill. Start at one end and work your way down. Check for any daylight coming through the seal and repeat tapping lightly until the insulating foam has a good seal.



FANTASTIC FRAME WINDOW INSERTS INSTALL GUIDE

INSTALLATION STEPS (CONT.)

10

Note: this step is only applicable to installs that requested a swivel clip or plastic handles

Flush Mount w/ Swivel Clip: Once window is in place, install swivel clips with provided screws. Make sure the tab on the clip is turned to cover the window trim.

Plastic Handles (removable): Plastic handles should be fitted into the space between the Fantastic Frame and the acrylic glass. Wiggle it in to fit.

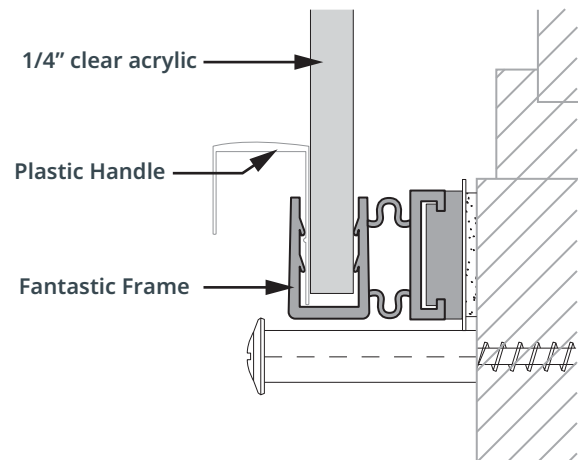
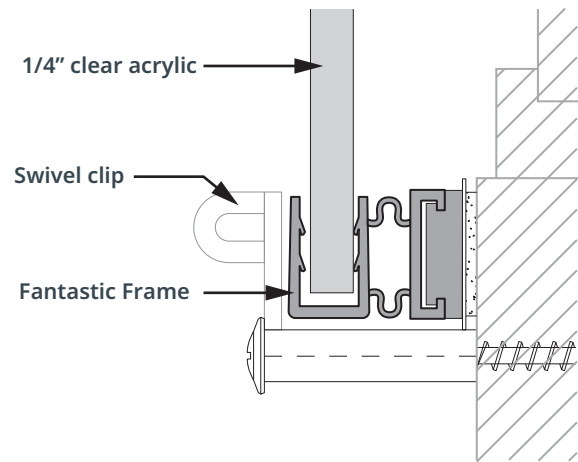

11

After all steps are complete and window insert is in place, you may remove the protective film on the interior side and repeat cleaning steps from step 8.

